

## SOPHIE

### Version

Island 54 - 600 m<sup>3</sup>/h - Pewter

### Collection

Circle.Tech

### EAN code

8034122476773



*The photograph is purely for information  
It may not correspond to the selected version.*

## FEATURES

**Metallic grease filter, removable and washable**  
**Optional remote control**  
**Perimeter suction with tempered glass panel**  
**Rotary Switch**  
**Circle.Tech technology with Carbon.Zeo Filters**  
**Painted Steel with Pewter finish**  
**Dynamic LED Light (2700K - 5600K)**

Strip LED 18w until 06.23.23

## OPTIONAL ACCESSORIES

### KACL.143

Cables adjustable up to 340 cm

### KACL.162#V4F

ø 22 cm lamp, Pewter

### KACL.163#V4F

ø 54 cm lamp, Pewter

### KACL.944

Carbon.Zeo spare filter kit for Circle.Tech hoods

### 105080053

Remote control

## TECHNICAL FEATURES

### Installation type

Island

### Dimensions

54 cm

### Finishing

Painted steel

### Motor

600 m<sup>3</sup>/h

### Type of control

Rotary Switch

### Speed settings

4

### Lighting

Strip Led - 2700 K / 5600 K

### Charcoal filter

Carbon.Zeo spare filter kit for Circle.Tech hoods (included)

### Minimum distance

Gas hob: 53 cm

Electric hob: 52 cm

## PACKAGING:WEIGHTS AND VOLUMES

### Gross weight

27 kg

### Net weight

20.9 kg

### Volumes

0.3 m<sup>3</sup>

### Packaging size

Length

775 mm

Height

550 mm

Depth

705 mm

## CONSUMPTION AND CONNECTION FEATURES

### Maximum consumption

160 W

### Voltage

220-240V

### Frequency

50-60Hz

## MOTOR TECHNICAL SHEET

### Maximum noise level

66 dB(A)re1pW

I.E.C.60704-2-13

### Max. motor power

130 W

## ENERGY CLASS

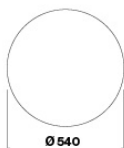
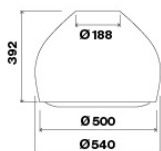

## SOPHIE

### Version

Island 54 - 600 m<sup>3</sup>/h - Pewter

### Collection

Circle.Tech

### EAN code

8034122476773

## MOTOR TECHNICAL SHEET

Motor speed	1	2	3	4
Noise level dB(A)re1pW-I.E.C.60704-2-13	47	53	60	66
Capacity (m <sup>3</sup> /h) I.E.C.61591				
Maximum pressure (Pa)				
Motor Power (W)	80	90	103	130
Air outlet				